



# American University Washington College of Law

# Project Status

- Demolition: COMPLETE
- Debris recycling for LEED certification: IN PROGRESS
- Excavation: IN PROGRESS (thru March 2014)
  - Pile Drilling: COMPLETE
  - Pile Driving: October 22 – November 15
- Concrete Work: December – November 2014

# Excavation Phase

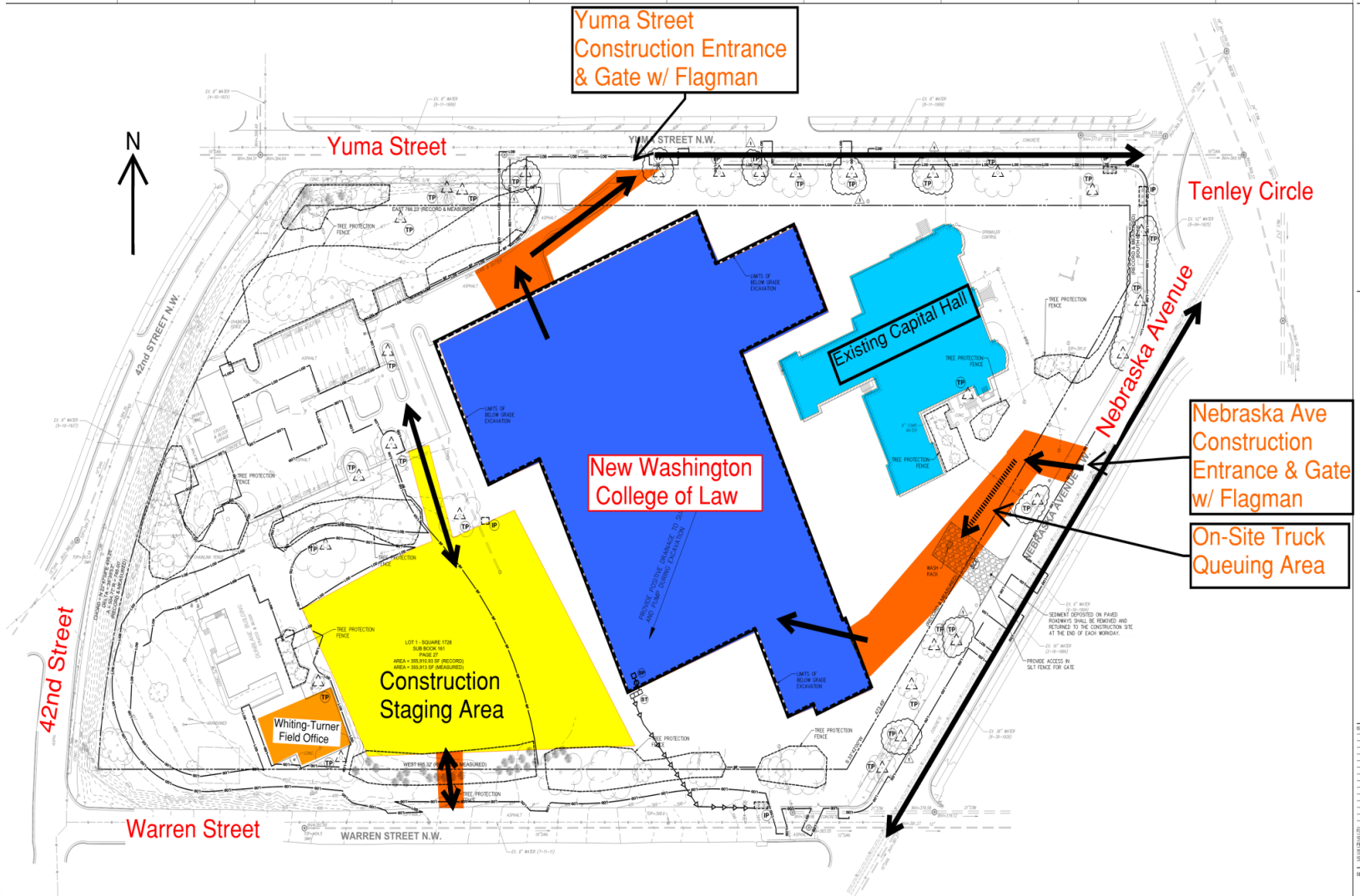

# Concrete Operation

- 29,000 cubic yards of concrete
  - Equals 2,900 ready mix truck deliveries
- On-site Concrete Batch Plant
  - Electric operation
  - Bulk material delivery
  - Uses stockpiles of cement, sand and gravel
  - On-site mixing
  - Hours of operation: 7:30am-4:00pm
  - Requires bulk deliveries of batch plant materials until 6:00pm
  - Requires use of Warren Street construction entrance

# On-Site Concrete Batch Plant



# Concrete Phase

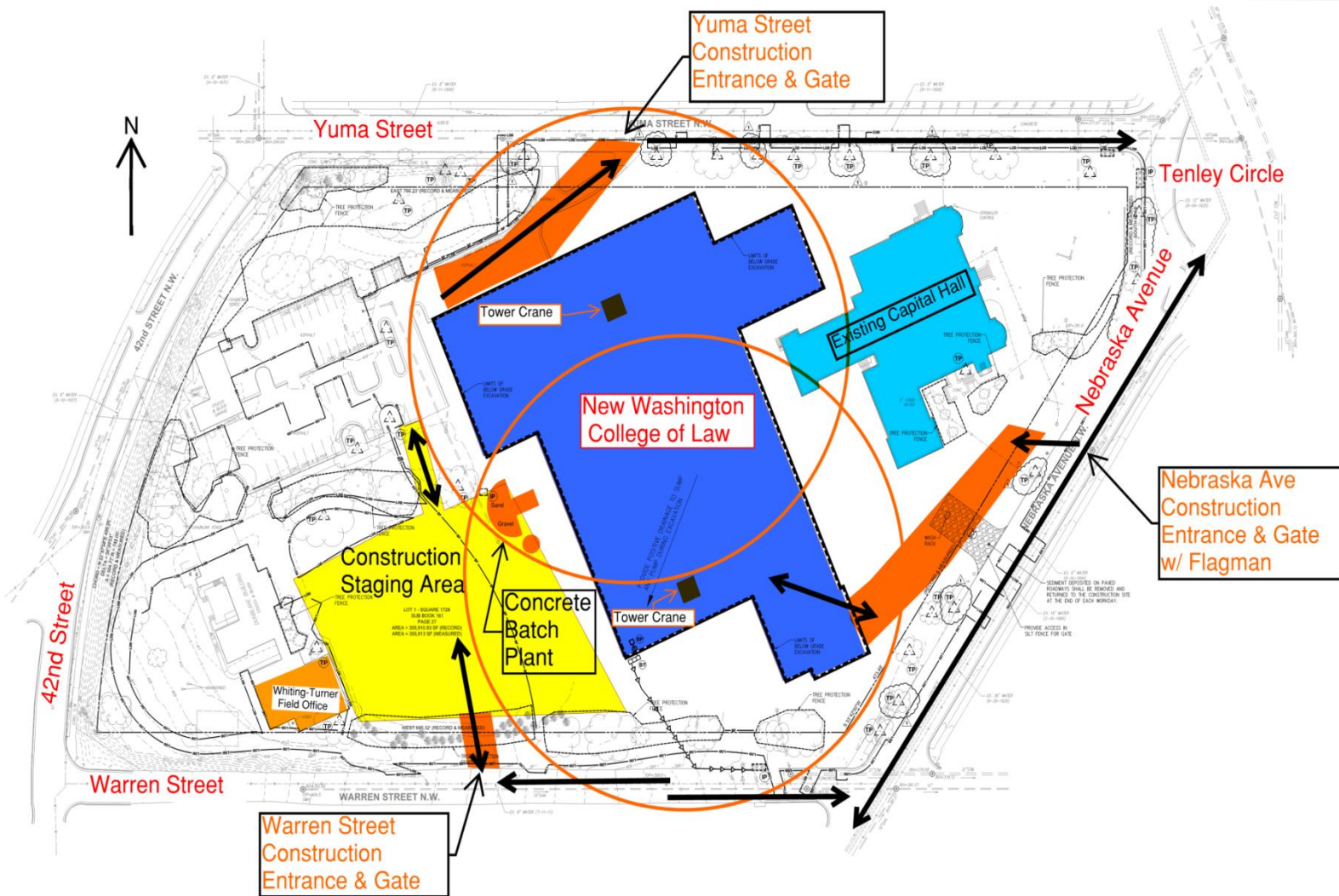

# Advantages of On-Site Concrete Batch Plant

- 50% or 1,500 fewer ready mix truck deliveries
- Fewer deliveries during morning rush hour
- Reduced truck traffic and less congestion on streets
- No increased noise levels
- Increased on-site construction staging availability